

1732 Font Hills Lane, Knightdale, NC 27545

\$549,900

- **3.95% rate fixed for 30 years; 3.98% APR***
- **Up to 100% financing for qualified buyers**
- **No origination fee**
- **No private mortgage insurance**



0359181 09/26/2008

4 Bedrooms - 3.5 Baths - 3012 sq ft, 1894 unfinished sp ft

MLS ID# 999445

Estates at Smith Crossings Subdivision

LISTING AGENT:

Susan Ramsey
919-874-7546

Chad Doggett
919-874-7559

Fonville Morisey Realty –Falls Sales Office

Under Construction! 3012 heated square feet plus 1894 square feet in unfinished basement. Basement is preplumbed, framed and wired to be finished at a later date. Walk-in Storage & Walk-up attic for additional storage on 3rd Floor! This home has all of the spaces you are looking for. Formal Dining Room. Two story Family Room with tons of light. Kitchen is open to the Breakfast and Keeping Rooms. Trey Ceiling in the Master Bedroom. Built in Desk/Study area on the 2nd Floor. Hardwood Floors on First Floor, Upgraded Carpet in all Bedrooms, Granite Countertops in Kitchen, Custom Designed Cabinets, Tile Baths, Heavy Trim, Masterfully appointed lighting and plumbing fixtures. Private Community Pool and Bath house coming in 2009. \$2000 "Buyers Choice" Incentive with Acceptable Offer

*Annual Percentage Rate (APR). Payment Example: \$300,000 purchase price, zero (0) down payment, loan amount \$300,000 payable in 360 monthly installments of \$1,423.95 (principal and interest) results in an APR of 3.98%. Must meet Capital Bank's underwriting and credit guidelines. Offer can be withdrawn by Capital Bank at its sole discretion without prior notice. Other terms and conditions are available. Rate subject to change without notice. Contact a Capital Bank representative for a full list of select homes or visit capitalbank-us.com/homes. Primary Residencies only. Rate and APR effective 1/1/10. Your actual APR may vary based on the amount of your loan and closing costs.



1732 Font Hills Lane, Knightdale, NC 27545

\$549,900

First Floor

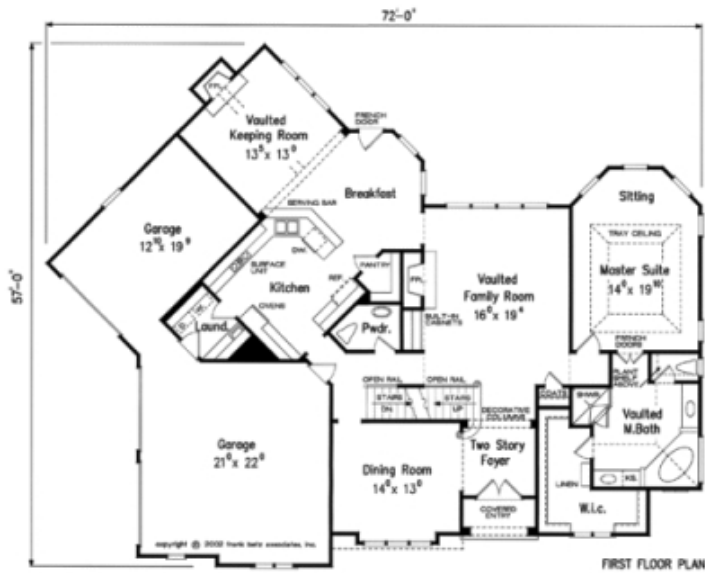

Second Floor

